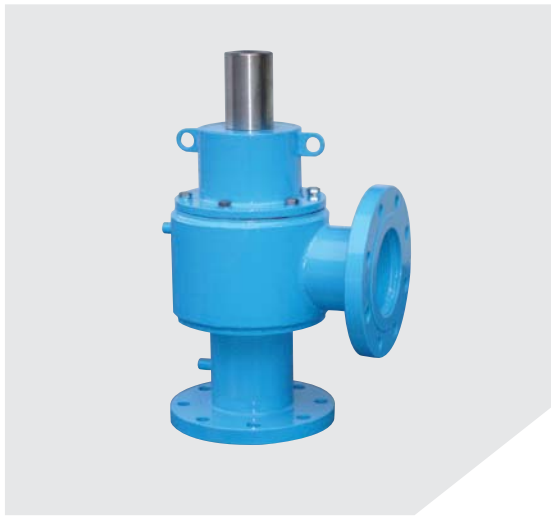

BREATHER VALVE Section 1.2**PRESSURE RELIEF VALVE WITH PIPE AWAY****KSBD/DS TYPE BREATHER VALVE**

The model KSBD and KSDS pressure vacuum valves are an advanced design for pipe away applications.

Designed manufactured and tested according to the API 2000 code.

Utilize the latest technologies to provide protection against positive or vacuum over pressure and prevent air intake, evaporative losses of product and help to contain odorous and potentially explosive vapours.

Introduction

The KSBD is a weighted pallet model, designed to handle over pressure with a minimum pressure of 20mmW.C and a maximum setting of 700mmW.C

The KSDS is a spring loaded model, designed to handle over pressure with a minimum pressure of 700mmW.C and a maximum setting of 7,000mmW.C.

Body materials are available in Aluminium, Carbon Steel, 304SS and 316SS with various trims to suit individual requirements.

Sizes range from 50mm through to 300mm with ANSI 150lb FF flanges as standard. (Different connections available on request).

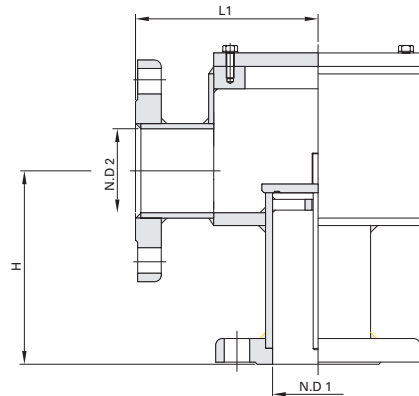
BREATHER VALVE Section 1.2**PRESSURE RELIEF VALVE WITH PIPE AWAY****KSBD/DS TYPE BREATHER VALVE****KSBD Weight Loaded Type**

For high pressure setting, **KSDS** Type Spring Loaded Valve are available on request.

Dimension Table

Unit = mm

SIZE	2" x 2"	3" x 3"	4" x 4"	6" x 6"	8" x 8"	10" x 12"	12" X 14"
N.D.1	50	80	100	150	200	250	300
N.D.2	50	80	100	150	200	300	350
L1	150	170	180	220	275	250	290
H	140	200	249	306	360	434	484

NOTES : Standard Connection : ANSI 150LB FF flange, JIS or different sizes available on request.

Materials of Construction

ITEM NO.	COMPONENT	BODY	ALUMINIUM	C.S	304 S.S	316S.S
		TRIM	304 S.S	304 S.S	304S.S	316 S.S
1	BODY		ALUMINIUM	C.S	304 S.S	316 S.S
2	SEAT		304 S.S	304 S.S	304 S.S	316 S.S
3	COVER		ALUMINIUM	C.S	304 S.S	316 S.S
4	BOLT/NUT		304 S.S	304 S.S	304 S.S	304 S.S
5	PALLET ASSEMBLY		304 S.S	304 S.S	304 S.S	316 S.S
6	PALLET WEIGHT			LEAD		
7	STEM		304 S.S	304 S.S	304 S.S	316 S.S